

**RESOLUTION NO. 2003-147**

**A RESOLUTION OF THE CITY COUNCIL OF THE CITY OF ELK GROVE  
PROVIDING FOR THE LEVY OF THE SPECIAL TAX IN THE CITY OF ELK GROVE  
COMMUNITY FACILITIES DISTRICT NO. 2003-1 (POPPY RIDGE)  
FOR FISCAL YEAR 2003-2004**

WHEREAS, the City Council of the City of Elk Grove (the "Council") on January 15, 2003, duly adopted its Resolution No. 2003-15 (the "Resolution") establishing the City of Elk Grove Community Facilities District No. 2003-1 (Poppy Ridge) (the "CFD") for the purpose of providing for the financing of certain facilities and services in and for the CFD and providing for the levy of a special tax in and for the CFD; and

WHEREAS, at an election held in the CFD on January 15, 2003, the qualified electors duly authorized the levy and collection of a special tax to be used for the purpose of paying the costs of the facilities and services; and

WHEREAS, the Council, on February 5, 2003, adopted its Ordinance No. 1-2003 (the "Ordinance") levying the special tax in CFD; and

WHEREAS, there has been submitted to the Council a special tax roll, which is on file with the City Clerk (the "Special Tax Roll"), for the CFD for Fiscal Year 2003-2004, which lists all parcels subject to the special tax levy and includes the amount of the special tax to be levied on each parcel, which amounts reflect rates that do not exceed the rates provided by the Ordinance; and

WHEREAS, summary information regarding the special taxes to be levied for Fiscal Year 2003-2004 is attached as Exhibit A hereto; and

WHEREAS, the Council has determined to levy the special tax at the rates specified in the Special Tax Roll and to apportion them in the manner specified in the Resolution.

**NOW, THEREFORE, BE IT RESOLVED** by the City Council of the City of Elk Grove that:

Section 1. Recitals. The foregoing recitals are true and correct and this Council so finds and determines.

Section 2. Levy of Special Tax. Pursuant to section 53340 of the Government Code of the State of California, the special tax is hereby levied at the rates specified in the Special Tax Roll and is hereby apportioned in the manner specified in the Resolution (and reflected in the Special Tax Roll).

Section 3. Adjustments to the Special Tax Roll. The CFD Administrator is hereby authorized to make changes to the Special Tax Roll prior to the final posting of the special taxes to the County tax roll. In response to appeals from taxpayers, or

otherwise to achieve a correct match of the special tax levy with the assessor's parcel numbers finally utilized by the County in sending out property tax bills or in order to correct errors that may, from time to time, arise in the application of the special tax to particular parcels.

Section 4. Tax Collection. Pursuant to section 53340 of the Government Code of the State of California, the special tax shall be collected by the Director of Finance of the County of Sacramento in the same manner as ordinary ad valorem property taxes are collected and shall be subject to the same procedure, sale, and lien priority in case of delinquency as is provided for ad valorem taxes, subject to all other conditions set forth in the Resolution.

Section 5. Filing the Special Tax Roll. In order to have the special tax levied hereby collected in the next tax collection period and thus available to finance the facilities approved by the electors of the CFD, the CFD Administrator shall deliver a certified copy of the Special Tax Roll to the Director of Finance of the County of Sacramento not later than August 10, 2003.

Section 6. Effective Date. This Resolution shall take effect immediately upon adoption.

**PASSED AND ADOPTED** by the City Council of the City of Elk Grove on this 6<sup>th</sup> day of August 2003.

  
SOPHIA SCHERMAN, MAYOR of the  
CITY OF ELK GROVE

ATTEST:

  
PEGGY JACKSON, CITY CLERK

APPROVED AS TO FORM:

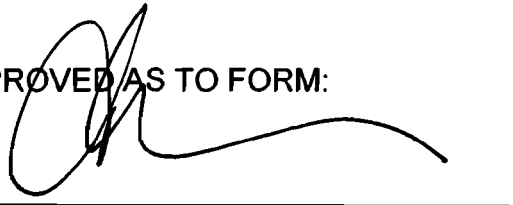
  
ANTHONY MANZANETTI,  
CITY ATTORNEY

**CERTIFICATION  
ELK GROVE CITY COUNCIL RESOLUTION NO. 2003-147**

STATE OF CALIFORNIA            )  
COUNTY OF SACRAMENTO        )        ss  
CITY OF ELK GROVE                )

***I, Peggy E. Jackson, City Clerk of the City of Elk Grove, California, do hereby certify that the foregoing resolution was duly introduced, approved, and adopted by the City Council of the City of Elk Grove at a regular meeting of said Council held on the 6<sup>th</sup> day of August, 2003 by the following roll call vote:***

**AYES: 5        COUNCILMEMBERS: Scherman, Soares, Briggs, Cooper, Leary**

**NOES: 0       COUNCILMEMBERS:**

**ABSTAIN: 0   COUNCILMEMBERS:**

**ABSENT: 0    COUNCILMEMBERS:**

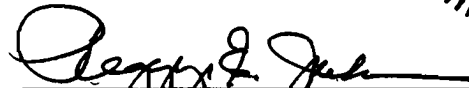

  
\_\_\_\_\_  
**Peggy E. Jackson, City Clerk  
City of Elk Grove, California**

## EXHIBIT A

### TOTAL FUNDS REQUIRED FOR FISCAL YEAR 2003-2004:

LEVY COMPONENTS	FY 2003/2004
Future Debt Service/District Projects	92,734.49
<b>Total Debt Service/District Projects</b>	<b>\$92,734.49</b>
<b>PUBLIC SAFETY SERVICES</b>	
Police Services	\$32,850.00
<b>Total Public Safety Service</b>	<b>\$32,850.00</b>
<b>ADMINISTRATIVE EXPENSES</b>	
<i>Staff Allocations</i>	
Accounting Staff	3,000.00
Engineering Staff	50,000.00
Agency Administration	25,000.00
Other Staff	2,500.00
Auditor's Fee (Total Fee x % for District)	1,500.00
Attorney's Fees (Total Fee x % for District)	12,000.00
<b>Total Agency Staff and Expenses</b>	<b>\$94,000.00</b>
Registrar/Transfer/Paying Agent Annual Fees (i.e. Bank Fees)	\$1,500.00
Bond Call Costs	\$0.00
<b>Total Registrar/Transfer/Paying Agent Fees</b>	<b>\$1,500.00</b>
Arbitrage Calculation Fees	1,750.00
County Auditor and Assessor Fees	302.51
MuniFinancial Fees	6,598.00
MuniFinancial Expenses	100.00
SEC Disclosure	2,150.00
<b>Total Other Fees</b>	<b>\$10,900.51</b>
<b>Total Administrative Expenses</b>	<b>\$106,400.51</b>
Reserve for Future Delinquencies	\$12,200.00
<b>TOTAL FUNDS REQUIRED FOR FISCAL YEAR 2003-2004</b>	<b>\$244,185.00</b>

**EXHIBIT A (CONTINUED)**

<b>Table 1</b> <b>Maximum Facilities Special Tax for Developed Property</b> <b>Community Facilities District No. 2003-1</b>						
<b>Land Use Class</b>	<b>Description</b>	<b>Maximum Facilities Special Tax Per Unit/Acre</b>	<b>FY 2003-04 Facilities Special Tax Per Unit/Acre</b>	<b>Number of Parcels</b>	<b>Estimated Fiscal Year 2003-04 Revenue</b>	<b>Percent of Maximum Tax</b>
1	Residential Property	\$965 per Unit	\$965.00	219	\$211,335.00	100.00%
2	Multi-Family Property	\$4,825 per Net Acre	-	0	0.00	-
3	Non – Residential Property	\$4,825 per Net Acre	-	0	0.00	-

<b>Table 2</b> <b>Maximum Public Safety Special Tax for Developed Property</b> <b>Community Facilities District No. 2003-1</b>						
<b>Land Use Class</b>	<b>Description</b>	<b>Maximum Public Safety Special Tax Per Unit/Acre</b>	<b>FY 2003-04 Public Safety Special Tax Per Unit/Acre</b>	<b>Number of Parcels</b>	<b>Estimated Fiscal Year 2003-04 Revenue</b>	<b>Percent of Maximum Tax</b>
1	Residential Property	\$150 per Unit	\$150.00	219	\$32,850.00	100.00%
2	Multi-Family Property	\$115 per Unit	-	0	0.00	-
3	Non – Residential Property	\$250 per Net Acre	-	0	0.00	-

**EXHIBIT A (CONTINUED)**

<p align="center"><b>Table 3</b>  <b>Maximum Facilities Special Tax for Undeveloped Property</b>  <b>Community Facilities District No. 2003-1</b></p>						
<b>Land Use Class</b>	<b>Description</b>	<b>Maximum Facilities Special Tax Per Unit/Acre</b>	<b>FY 2003-04 Facilities Special Tax Per Unit/Acre</b>	<b>Number of Parcels</b>	<b>Estimated Fiscal Year 2003-04 Revenue</b>	<b>Percent of Maximum Tax</b>
4	Final Map Residential Property	\$965 per Lot	-	466	0.00	-
5	Large Lot Property	\$4,710 per Gross Acre	-	0	0.00	-
6	Tentative Map Property	\$3,675 per Gross Acre	-	23	0.00	-
7	Other Taxable Property	\$3,675 per Gross Acre	-	0	0.00	-
<b>TOTAL:</b>				<b>219</b>	<b>\$244,185.00</b>	

# EXHIBIT A (CONTINUED)

**CLERK'S CERTIFICATE AND MAP FILING STATEMENT**

FILED IN THE OFFICE OF THE CITY CLERK OF THE CITY OF ELK GROVE, COUNTY OF SACRAMENTO, STATE OF CALIFORNIA, THIS \_\_\_\_\_ DAY OF \_\_\_\_\_, 200\_\_\_\_.

I HEREBY CERTIFY THAT THE MAP SHOWING BOUNDARIES OF CITY OF ELK GROVE COMMUNITY FACILITIES DISTRICT NO. 2003-1 (POPPY RIDGE), WITHIN THE CITY OF ELK GROVE, COUNTY OF SACRAMENTO STATE OF CALIFORNIA, WAS APPROVED BY THE CITY COUNCIL OF THE CITY OF ELK GROVE AT A REGULAR MEETING THEREOF HELD ON THE \_\_\_\_\_ DAY OF \_\_\_\_\_, 200\_\_\_\_, BY ITS RESOLUTION NO. \_\_\_\_\_.

**COUNTY RECORDER'S FILING STATEMENT**

FILED THIS \_\_\_\_\_ DAY OF \_\_\_\_\_, 200\_\_\_\_, AT THE HOUR OF \_\_\_\_\_ O'CLOCK P.M. IN BOOK \_\_\_\_\_ OF MAPS OF ASSESSMENT DISTRICTS AND COMMUNITY FACILITIES DISTRICTS AT PAGE \_\_\_\_\_ IN THE OFFICE OF THE COUNTY RECORDER OF THE COUNTY OF SACRAMENTO, STATE OF CALIFORNIA.

**CITY OF ELK GROVE  
COMMUNITY FACILITIES DISTRICT NO. 2003-1  
(POPPY RIDGE)  
CITY OF ELK GROVE - COUNTY OF SACRAMENTO - STATE OF CALIFORNIA  
SHEET 1 OF 1 SHEETS**

COUNTY RECORDER OF THE COUNTY OF SACRAMENTO, CALIFORNIA

CITY CLERK, CITY OF ELK GROVE, CALIFORNIA

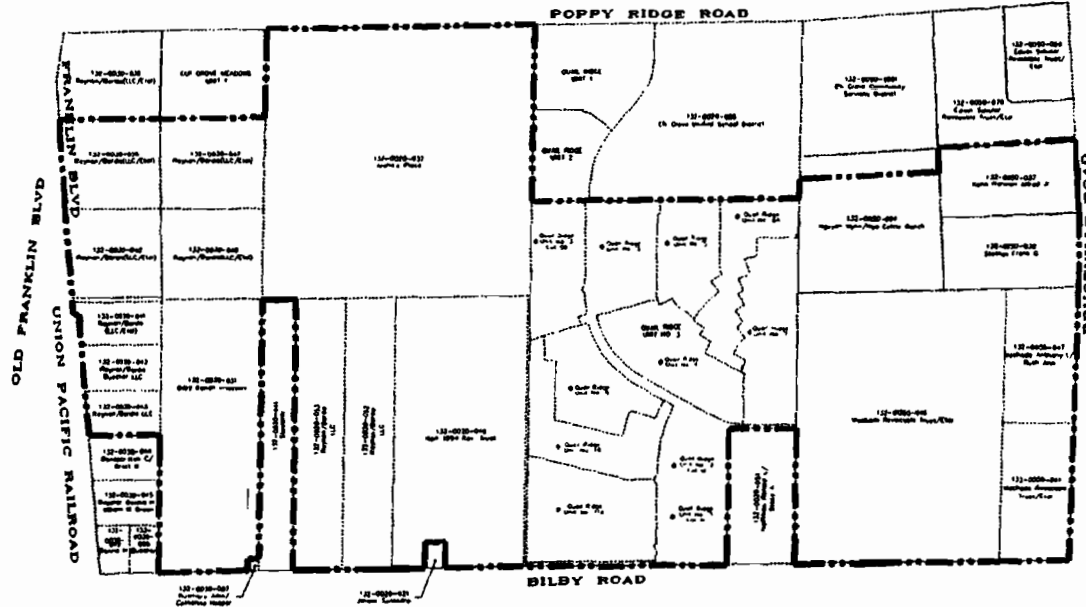

■■■■■ COMMUNITY FACILITIES DISTRICT BOUNDARY

\* = APN # TO BE ASSIGNED IN THE FUTURE

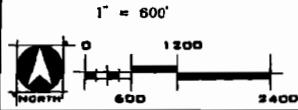

**WOOD ROGERS**  
ENGINEERS - PLANNERS - ARCHITECTS - 1947-1970  
2301 C St., 95610-0000 Tel: 916-341-7700  
Sacramento, Ca. 95816 Fax: 916-341-7701