

Phone: 916.683.7111  
Fax: 916.627.4400

[www.elkgrovecity.org](http://www.elkgrovecity.org)

PUBLIC WORKS  
8401 Laguna Palms Way  
Elk Grove, California 95758



## Standards Update Transmittal

Reference Number: 2024-14  
Standards: Standard Construction Specifications, Section 38  
Improvement Standards, Section 9-11, 9-12, 9-24, 9-25  
**Update:** Standard Drawings, ST-10 & SD-23

1. Modification to Standard Construction Specifications:
  - a. Section 38-9.03, was a reserved section. This section will now be titled “Plastic Pipe Deflection Testing.”
2. Modifications to Improvement Standards:
  - a. Section 9-11, HYDRAULICS, 9-12, CLOSED CONDUITS, 9-24, DRAINAGE IN RURAL AREAS and 9-25, STORM DRAIN SYSTEMS IN PRIVATE STREETS.
3. Modifications to Standard Drawings:
  - a. Standard Drawing ST-10, TRENCH SECTIONS IN IMPROVED AREAS HORTICULTURE, LAWN, OR CULTIVATED AREAS and SD-23, PIPE CONNECTIONS
4. Deletion of Standard Drawings:
  - a. Standard Drawings SD-20, DRAINAGE INLET TYPE H, SD-21.1, CORRUGATED METAL PIPE DRAINAGE INLET TYPE I (PG 1 OF 2), SD-21.2, CORRUGATED METAL PIPE DRAINAGE INLET TYPE I (PG 2 OF 2) and SD-22, CORRUGATED PIPE FITTINGS

### Effect of Update:

1. Modifications are as follows:
  - a. Standard Construction Specifications Section 50 added a new section, “Plastic Pipe.” Section 38, “Plastic Pipe Deflection Testing” is being added to the Standard Construction Specifications to ensure the final product does not exceed the deflection limitations.
2. Modifications are as follows:
  - a. Sections 9-11, 9-12, 9-24 and 9-25 are being modified due to:
    - i. Metal Pipe is no longer being allowed in the City limits. Metal pipe references and specifications are deleted.
    - ii. Polypropylene Dual Wall Pipe is being allowed within City limits for drainage only. Specifications were updated to allow this type of pipe.
3. Modifications are as follows:

2023-TBD  
Page 2 of 2

- a. Standard Drawing ST-10 was edited to show bedding under the pipe and clarify the excavation backfill areas.
- b. Standard Drawing SD-23 deletes details that included metal pipe.
- 4. Modifications are as follows:
  - a. Standard Drawings SD-20, SD-21.1, SD-21.2 and SD-22 are being deleted because metal pipe is no longer allowed within the City limits.

Request for Update Initiated By: Standard Review Committee 09/30/2023

Update Reviewed for Conformity and Consistency to Standards:

Shoaib Ahrary 4/25/2024 | 1:29 PM PDT  
Shoaib Ahrary, PE, ESD Manager Date

Update to Standards Approved:

Jeffrey R. Werner 4/29/2024 | 5:53 AM PDT  
Jeffrey R. Werner, PE, City Engineer Date

**NOTES:**

- 1. SEE STANDARD DRAWING SD-6.1 AND SD-6.2 FOR GEOTEXTILE REQUIREMENTS.

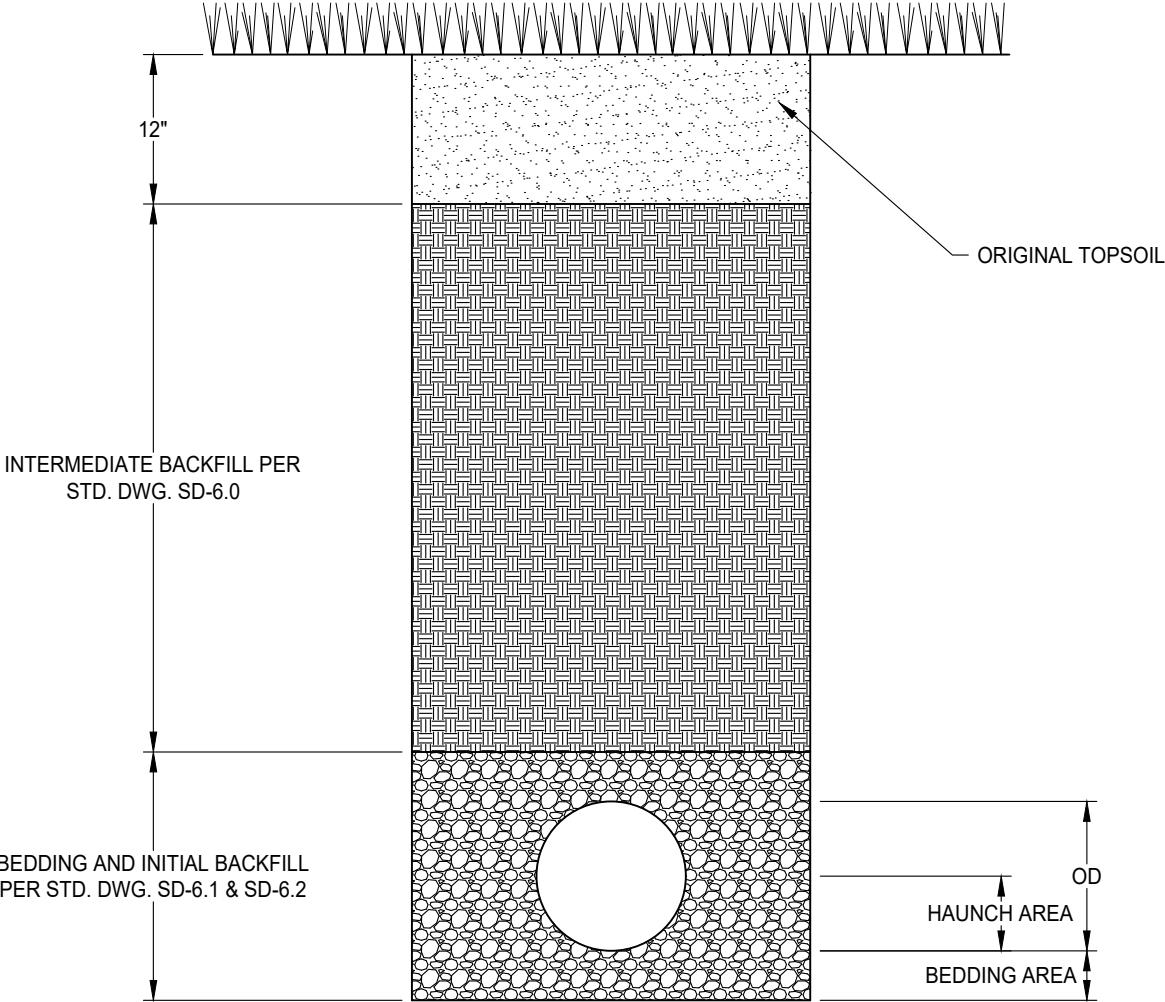

DATE: 09/22/2017		NOT TO SCALE	
REVISION	BY	APPROVED	DATE
1	SJB	SMA	02-28-2024

CITY OF ELK GROVE - PUBLIC WORKS

**TRENCH SECTIONS IN IMPROVED AREAS  
HORTICULTURE, LAWN, OR CULTIVATED  
AREAS**

APPROVED BY:  
*Jeffrey B. Wan* 04-29-2024  
CITY ENGINEER DATE

DRAWING NUMBER  
**ST - 10**



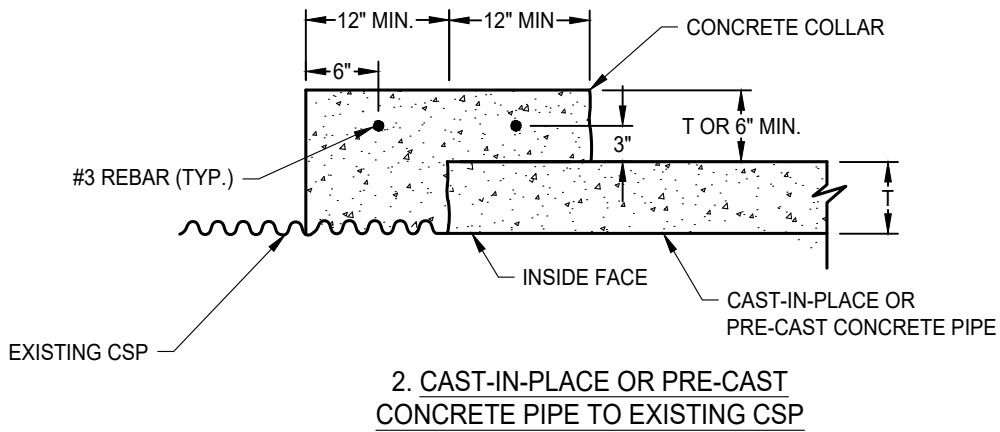
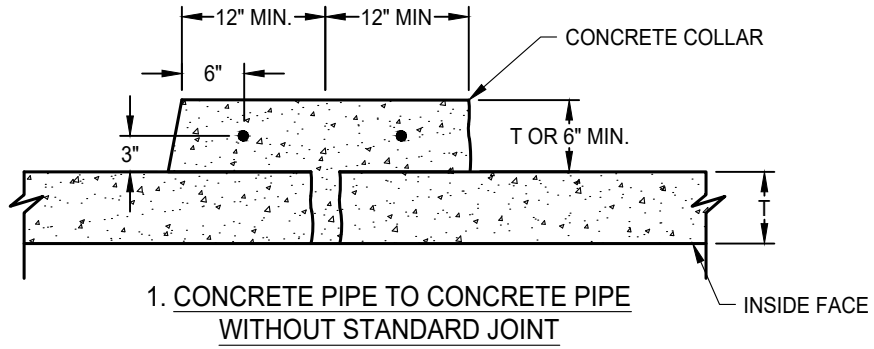

DATE: 09/22/2017		NOT TO SCALE	
REVISION	BY	APPROVED	DATE
1	SJB	SMA	02-28-2024

CITY OF ELK GROVE - PUBLIC WORKS

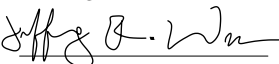
APPROVED BY:  
  
 CITY ENGINEER      DATE: 04-29-2024

**PIPE CONNECTIONS**



DRAWING NUMBER  
**SD - 23**